

Molina

A warm and welcoming more traditional look has been created for this model. Rich colours, sumptuous fabrics and attention to detailing has created a holiday home which is truly relaxing and luxurious, a real home from home.

The lounge has wonderful feature windows which allows light to flood into the living room, highlighting the rich colour scheme. Feature lighting allows you to choose your ambience. The kitchen and dining area are well laid out and fully equipped to give you all the working and eating space you need. The bedrooms have been designed using calming tranquil colours to ensure your relation through the night. Ample storage space within wardrobes (sliding feature mirror doors in master bedroom) and drawers means all your clothes and accessories can be stored away. This model has a spacious family shower room with storage facilities and a separate wc for the master bedroom.

STANDARD FEATURES

- UPVC doubled glazed windows & door/s
- Gas combi central heating
- Extra insulation
- Steel pantile roof
- Woodgrain effect aluminium cladding to exterior
- Lagged pipes
- Exterior light
- Feature stone effect electric fire suite
- TV unit
- Dining table & chairs
- Gas oven & hob
- S/Steel cooker hood
- Built in 70/30 full height fridge freezer
- Kitchen glass display cabinets
- Domestic interior doors
- Gas ram bed with underbed storage to main bedroom
- Foldout bed to lounge seating
- Vaulted ceiling throughout
- Thermostatic shower mixer

OPTIONAL FEATURES

- Pre galvanised chassis

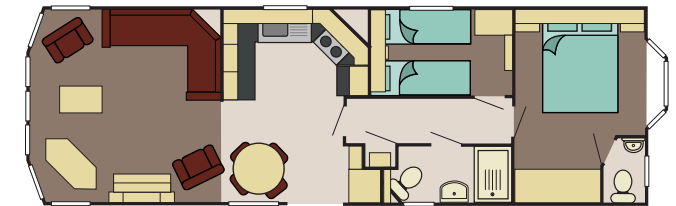

38 x 12 2 Bed

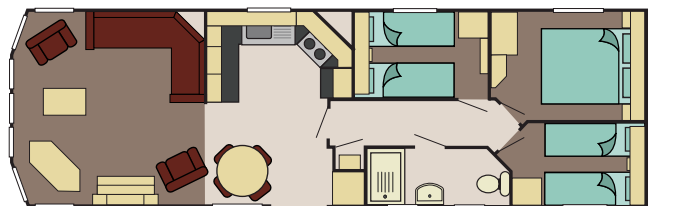

38 x 12 3 Bed



