

Superior

The Superior features a double sliding patio door within a full glass front gives you direct access to your own deck. The living room is wonderfully inviting, with comfortable seating incorporating a fold out occasional bed and co-ordinated scatter cushions. The bedrooms, include plush headboards and co-ordinated curtains. The modern stylish kitchen has high gloss doors with led plinth lights and under unit lighting with many integrated appliances and an American style fridge freezer.

The Superior has a light and spacious bathroom with a shower above the bath plus a second shower room featuring a large shower enclosure; both include mirrored cabinets and dual flush toilets.

If you are after a holiday home that has everything the Superior is Holiday home to view.



STANDARD FEATURES

- Upvc double glazed windows and door/s
- Gas combi central heating system
- Steel pantile roof
- PVC cladding to the exterior
- Lagged pipes
- Exterior light
- Feature fireplace with tv points and twin Hdmi connections
- Dining table & chairs
- Gas oven & hob
- S/Steel cooker hood
- Integrated dishwasher
- Integrated washer dryer
- Inbuilt microwave
- American style fridge freezer
- Domestic interior doors
- Gas ram bed with under bed storage to main bedroom
- Foldout bed to lounge seating
- Vaulted ceiling throughout
- Thermostatic shower mixer

OPTIONAL FEATURES

- Pre galvanised chassis

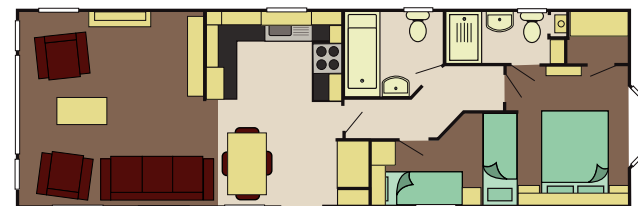

40 x 13 2 Bed



40 x 13 3 Bed



SEATS



CARPETS



BEDS



WARDROBE STORAGE



BATHROOM

